

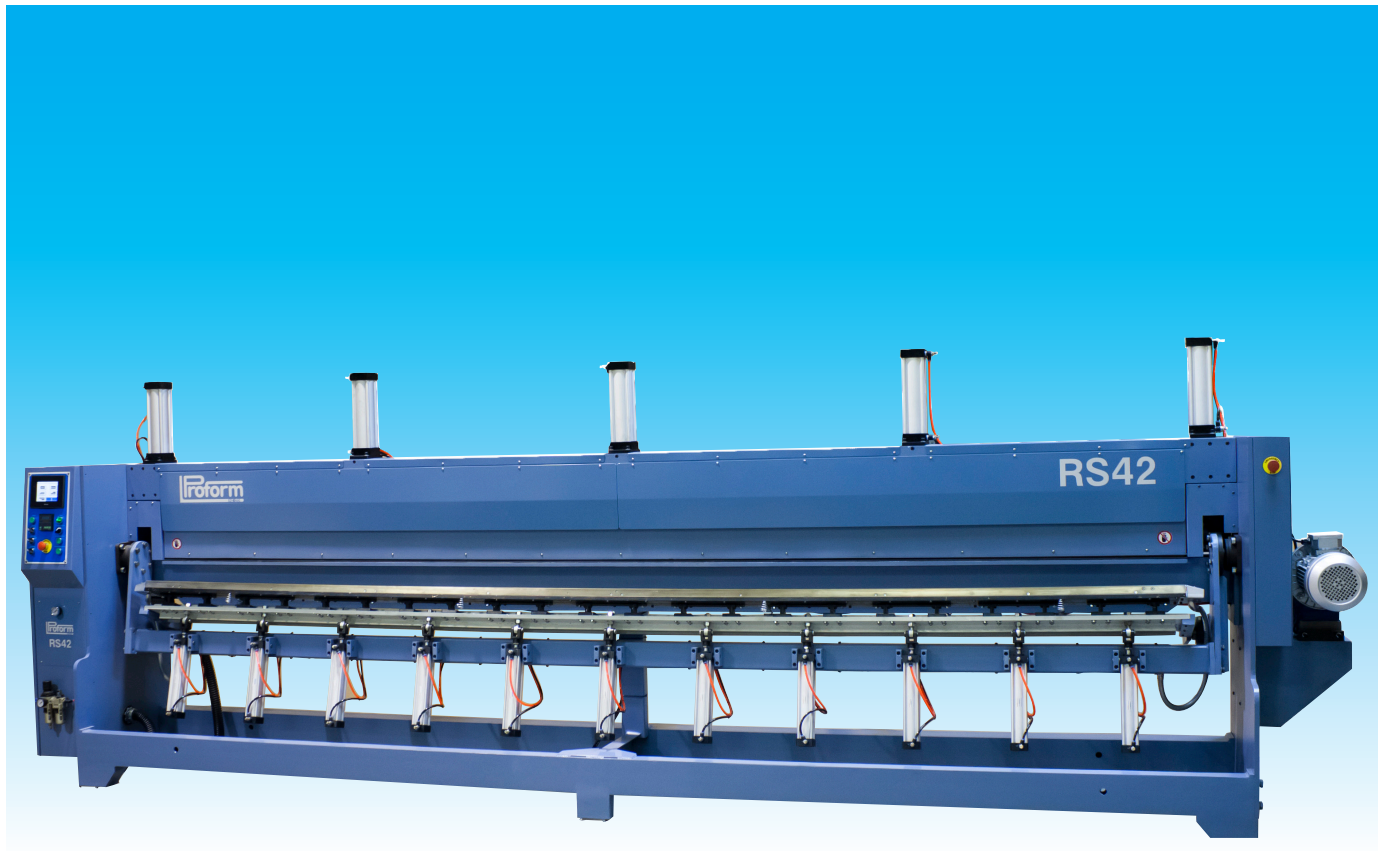

**Model: RS42**



- ☐ **Full colour touch screen**
- ☐ **PVAC & UF resin glue capability**
- ☐ **Fully automatic with manual over-ride options**
- ☐ **Gentle forming method produces tight rolls in 90 - 180 degrees, D-rolls and post formed doors etc.**
- ☐ **Space saving single-sided machine**
- ☐ **Forming up to 4200mm in length**

***Fully Automatic***

## Features

The RS42 is controlled by an electronic PLC and features a full colour touch-screen. This enables the RS42 to perform all the forming cycles in automatic mode, freeing the operator to complete other tasks e.g. preparing the next panel to be formed.

From the automatic menu the operator can select any of the 25 saved programs to be run in Auto mode. Each of the 25 saved programs can also be customized to suit a particular roll profile by changing the 10 variable start/stop positions. These alterations can then be saved to suit that profile. The machine can also be run in manual mode, allowing the operator to run each step of any sequence independently.

The gentle forming motion of the heated forming bar on the RS42 enables the machine to post form suitable laminates around a 3mm radius.

This gentle forming motion is also ideal when post forming end-rolls, and more difficult laminates.



## The Post forming Process

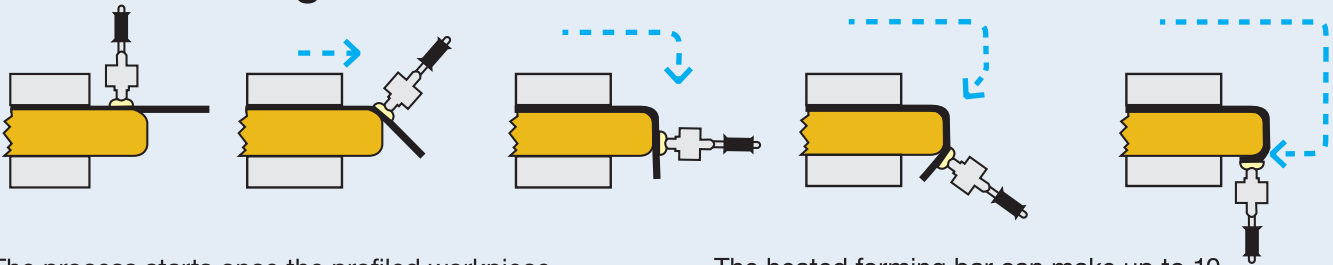

The process starts once the profiled workpiece (with laminate pressed to the surface) has had adhesive applied with a spray gun. The profiled work piece is placed into the machine and correctly positioned, using the locating stops. The operator then presses the Auto Start button to start the cycle, which automatically forms the overhanging laminate around the profile edge. The heated forming bar heats the laminate so it can be formed and also activates the glue as the forming bar is driven gently around the profile edge by means of an electro-mechanical drive system.

The heated forming bar can make up to 10 pre-selected stops at critical points along the profile during application. The laminate is held under pressure during the complete post-forming cycle, and the heated forming bar automatically adapts to suit the various profiles. The temperature of the bar is electronically controlled and displayed on the control panel.

## The Capabilities

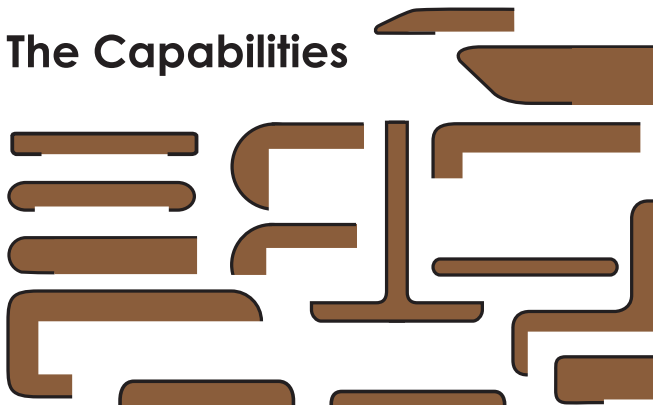

## Technical Specifications

Maximum bench top length	4200mm
Maximum Profile height	150mm
Minimum Profile height	16mm
Minimum Forming Radius	3mm
Splash Backs	up to 900mm high
Coving Radius	8mm
Machine Dimensions	L-5400 x W-700 x H-1800mm
Power Supply	415V + Neutral 25 amp
Air Supply	100 psi
Weight	2100kgs
OPTIONS: Coving bar and Vacuum clamping for splash backs.	